



^PURLIVE

# BUILDING SYSTEMS

# PURLIVE

Construction systems  
that save time,  
money, and the  
environment.

# 25 years

**PURLIVE construction systems** are designed to meet the most demanding requirements of 21st-century construction – quality, fast implementation with minimal labor, low construction costs, maximum usable space, the lowest building operation costs, safety, ecology, and sustainability. We collaborate with global companies such as BAYER DE, PLIXXENT DK, VELOX AT, Kronospan, Fermacell, Cetris, JAF HOLZ, VVUD, ADMD, ČVUT Praha, and others. Innovation is a continuous process for us.

**We have been manufacturing construction materials for 25 years.** Our business group includes concrete production, concrete logistics, the production of concrete products, aggregate production, limestone mining and grinding, container rental, modularity, development, construction implementation, wood processing, and the production of construction systems, such as SIP – Structural Insulated Panels.

# Zlín

## What sets us apart?

### ↗ Sustainability

We build using eco-friendly materials and optimize processes to minimize ecological impact.

### ↗ Customer-Centric Approach

Each project is tailored to the customer's specific needs, and we provide support from design to implementation.

### ↗ Innovation and Quality

Continuous development and the highest quality are our constants.

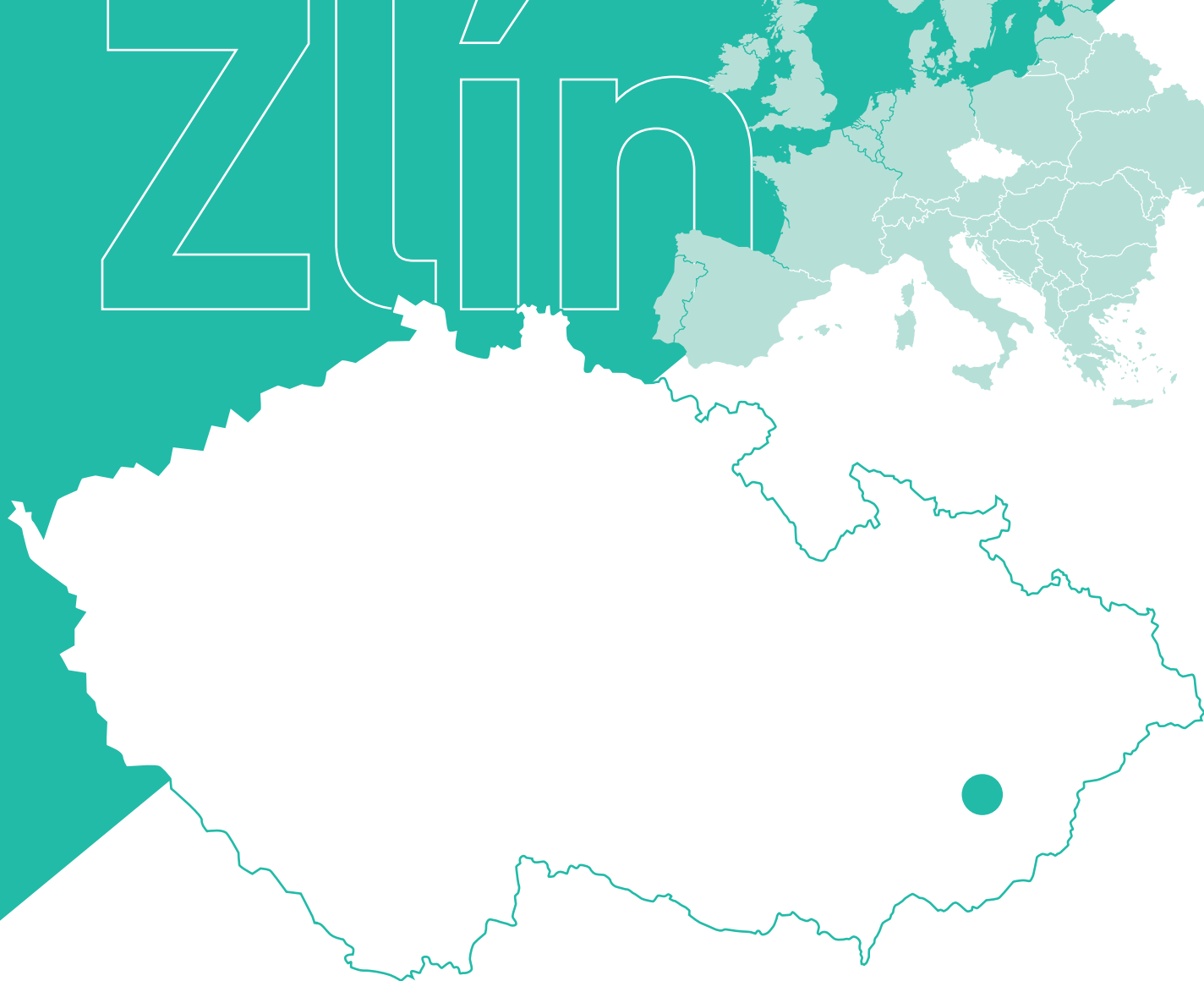

### ↗ Where can you find us?

PURLIVE, Ltd.  
Rybníky VII 5547  
760 01 Zlín



# ADVANTAGES THAT MAKE **PURLIVE A LEADER**



**Sustainability**



**Time  
efficiency**



**Cost-  
effectiveness**

**Certified**



**Dřevařský ústav**  
Timber Institute





## Water resistance

## High durability

## Weight

significantly lighter than masonry systems but heavier than the Two-by-Four timber construction system

## Health safety

all materials are certified

## Stable insulation

no settling in the structures

## Comparison of competing building systems

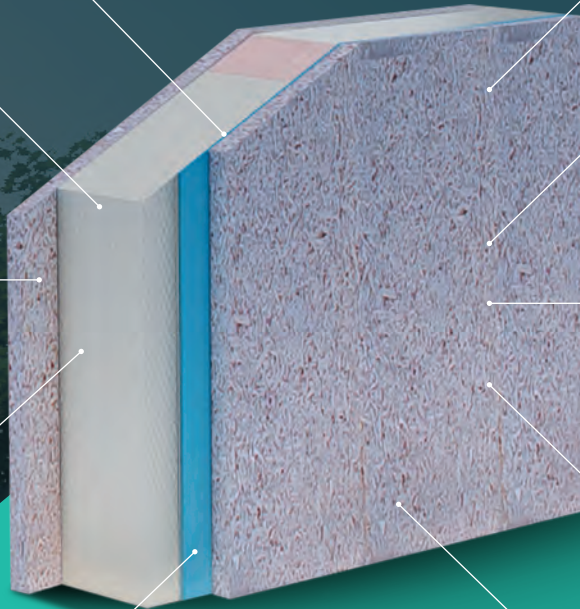

## High fire resistance

basic fire resistance of REI 45 minutes or more as required

## Static load-bearing capacity for multi-story buildings

## Acoustics

basic airborne sound insulation starting at 36 dB or higher as required

## Thermal transmittance coefficient

starting at  $U=0.118 \text{ W/m}^2\text{K}$ , PURLIVE W230

## Thermal conductivity coefficient of PURLIVE insulation

$0.021 \text{ W/mK}$

System	Thickness	U	Total Thickness
PURLIVE W170	170 mm	0,171	170 mm
Porotherm 25 Eko	250 mm	0,38	500 mm
Ytong 250 statik plus	250 mm	0,61	450 mm
Timber Construction (OSB, mineral wool 120 mm, OSB)	160 mm	0,277	430 mm (140 mm wool in structure + 140 mm EPS)

# VALUES YOU WON'T FIND ELSEWHERE

## Time

one floor in one day, reduced financing costs, earlier rental revenues

01

## Price

affordable and guaranteed costs

02

## Maximum usable space

optimal use of the built-up area

03

## Low operating energy costs

the most energy-efficient building system on the market

04

## Minimal labor on-site

One floor in one day (three workers)

05

## Support for designers and builders

06

## Speed of construction

reduced financing costs and earlier rental income

07

## Possibility of winter construction

08

## Dry, quiet, dust-free construction

09

## Minimal construction site occupation

10

## Weather-resistant PURLIVE system at the construction site

11



# IMPLEMENTATION PROCESS

We Manufacture.



We Deliver.



We Build.





# PURLIVE PRODUCTS

Quality and innovation

## Composition of PURLIVE W170 Panel

Velox WS Board, Thickness 25 mm,  
Vapor Barrier, KVH Timber Beam,  
60/120 mm + Thermal Insulation Made of  
PUR Foam, Thickness 120 mm,  
Velox WS Board, Thickness 25 mm.

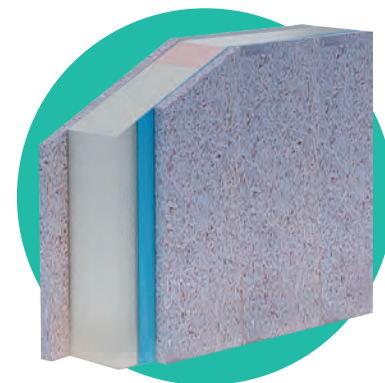

## PURLIVE W170 Load- Bearing Wall Structure

Steel substructure for the facing wall  
with drywall board, thickness 12.5 mm,  
**PURLIVE W170 panel** – Velox WS board,  
thickness 25 mm, vapor barrier, KVH timber  
beam, 60/120 mm + thermal insulation made  
of PUR foam, thickness 120 mm, facade  
polystyrene EPS, thickness 100 mm, facade  
plaster, paint.

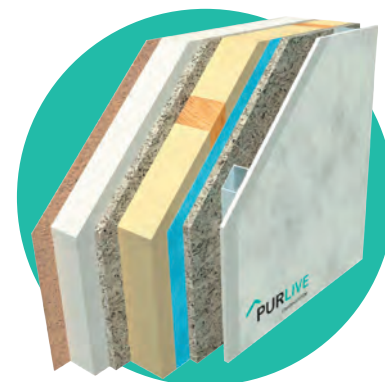



## Internal Load-Bearing Wall 161

Paint + Drywall Board, Thickness 12.5 mm, OSB Board, Thickness 18 mm, KVH Timber Beam, 60/100 mm + Acoustic Insulation, Thickness 100 mm, OSB Board, Thickness 18 mm, Drywall Board, Thickness 12.5 mm + Paint.

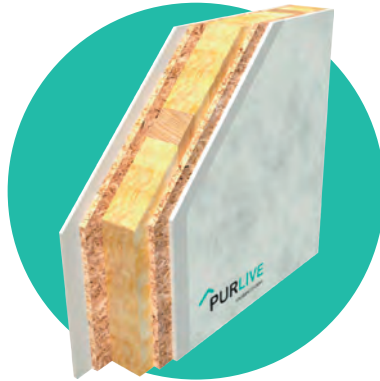

## PURLIVE SIP 150

OSB board, thickness 15 mm, KVH timber beam, 60/120 mm + thermal insulation made of PUR foam, thickness 120 mm.

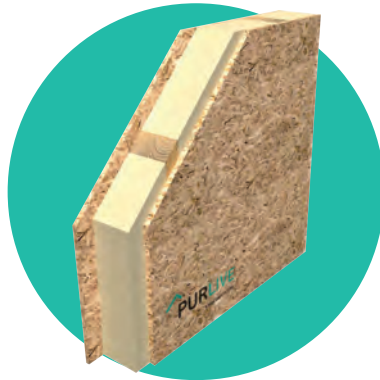

## Roof Module for Modular Construction

MDF board, PUR foam, wood.

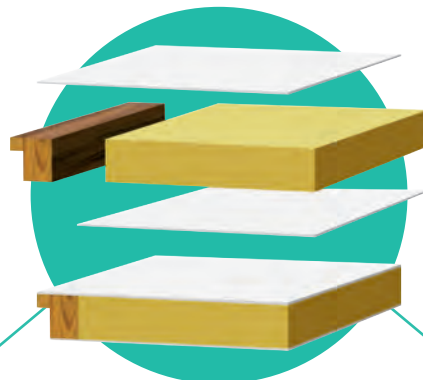

## Ceiling Structure

Walking Layer, Thickness 10 mm, Anhydrite Screed, Thickness 60 mm, PE Foil with Reflective Aluminum Layer, Thermal Insulation Made of EPS, Thickness 30 mm, Impact Sound Insulation Made of Basalt Boards, Thickness 20 mm, Covering Board – OSB Board, Thickness 22 mm, Ceiling KVH Beam, 60/240 mm + Along the Perimeter of the House, 500 mm Wide + Inserted Mineral Insulation, Thickness 2× 120 mm, vapor Barrier, Steel Substructure for the Suspended Ceiling + Fire-Resistant Drywall Board, Thickness 12.5 mm + Paint.

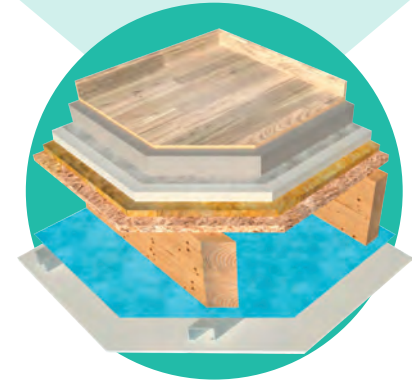

## Roof Structure

Roofing Material, Battens, 40/60 mm, Counter-Battens, 40/60 mm, Diffusion Membrane, Rafters Made of KVH Timber, 80/200 mm + Thermal Insulation Made of Mineral Wool, Thickness 200 mm Drywall Board, Thickness, 12.5 mm + Paint, Vapor Barrier, Steel Substructure for the Suspended Ceiling + Thermal Insulation Made of Mineral Wool, Thickness 40 mm, Drywall Board, Thickness 12.5 mm + Paint.

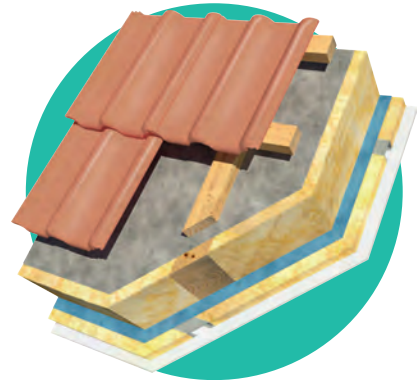

## Floor Panel

P5 board, PUR foam, wood, sheet metal.

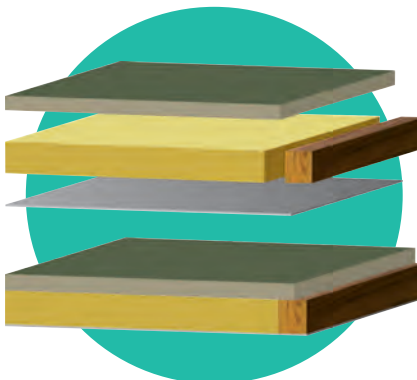

# PARTNERSHIP THAT MAKES SENSE

## 01 Construction Companies

PURLIVE is your reliable partner for efficient and fast project implementation. Thanks to our systems you will get:

- **Fast Assembly:** Prefabricated structures allow for record-time completion of the building shell.
- **Cost Savings:** We eliminate material waste and reduce labor requirements.
- **High Quality:** Certified panels with long life spans and minimal maintenance.
- **Full Support Throughout the Project:** From design to implementation, we are here for you.

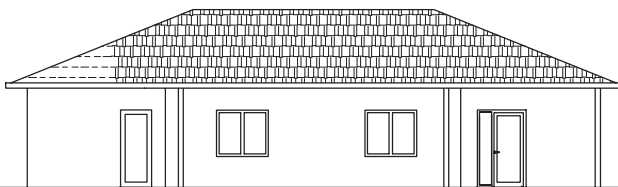

## 02 Architects/Designers

With us, you can offer your clients modern and efficient solutions:

- **Design Flexibility:** Our construction systems allow for easy adjustments to meet your needs.
- **Technical Support:** Consultations, 3D models, and detailed documentation tailored to your project.
- **Energy Efficiency:** PURLIVE systems meet the highest energy-saving standards.
- **Reliability:** Our prefabricated panels are manufactured with maximum precision.

## 03 Developers

Maximize profits and minimize risks with our building systems:

- **Efficient Process:** Fast construction reduces the return-on-investment period.
- **Attractive Selling Points:** Homes with lower operational costs and modern design.
- **Wide Range of Applications:** Single-family homes, apartment units, or commercial buildings.
- **Cost Fixation:** Stable material prices and prefabrication protect your investment from market fluctuations.



## 04 Institutions

PURLIVE is the ideal solution for public projects and buildings:

- **Fast Implementation:** Schools, offices, or healthcare facilities can be completed in a fraction of the usual time.
- **Economical Advantages:** Cost-effective structures reduce construction and operational costs.
- **Sustainability:** Eco-friendly materials and a low environmental impact.
- **Long Life Span:** Certified panels guarantee reliability for decades.

## 05 Families

Build your dream home quickly, efficiently, and affordably:

- **Project Services:** We provide a standard project or create a custom design.
- **Engineering Services:** We handle building permits and final inspections.
- **Partial Construction Assistance:** Save up to 30% of the overall cost of a turnkey home.
- **All PURLIVE Advantages:** Benefit from the unparalleled features of PURLIVE construction systems.

## 06 Steel Container Manufacturers

Increase efficiency and quality with PURLIVE:

- **Floors, Walls, and Roofs:** We supply insulated panels for steel frame assembly.
- **Energy-Efficient Containers:** PURLIVE ensures your products are significantly more energy-efficient.
- **High Quality:** Substantial improvement of floors, ceilings, and wall construction.
- **Production Efficiency:** Minimize on-site work, save time, and reduce labor costs.
- **More Space:** Our products provide greater usable space and interior height.



**PURLIVE is more than a supplier – we are a partner who will help you achieve your goals. Contact us, and let's build the future together!**

# WHAT CAN WE **BUILD**?



**Floating Homes**



**Commercial Spaces**  
cafés, hair salons, shops, rental services



**Senior Living Complexes**



**Administrative Buildings**







## Healthcare and Educational Facilities



## Standard and Custom-Built Family Homes



## Modular Assemblies



## Development Projects



## Institutions



# OUR PROJECTS



**Efficient Solutions for  
Smart Homes.**





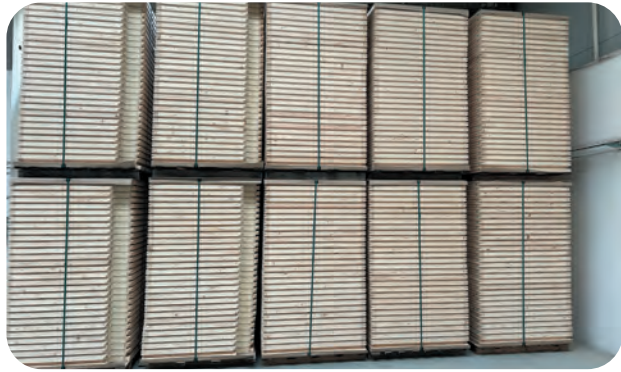

## Modular Timber Constructions Adapted to Your Dreams.







**PURLIVE, Ltd.**

Rybníky VII 5547

760 01 Zlín

info@purlive.cz

[www.purlive.cz](http://www.purlive.cz)



**Co-financed by  
the European Union.**



Ministry of  
Industry and Trade